

£1,400 Per Calendar Month

Admiralty Road, Portsmouth PO1
3GW

bernards
THE ESTATE AGENTS



HIGHLIGHTS

- ❖ TWO BEDROOM
- ❖ EN-SUITE
- ❖ ALLOCATED PARKING
- ❖ ADMIRALTY QUARTER
- ❖ FULLY FURNISHED
- ❖ MODERN THROUGHOUT
- ❖ AVAILABLE JANUARY 2025
- ❖ COUNCIL TAX BAND D

We are delighted to welcome this TWO BEDROOM APARTMENT to the rental market, located in Admiralty Quarter.

The property comes FULLY FURNISHED and boasts TWO DOUBLE BEDROOMS, one with an en-suite shower room, a large open plan living area flooded with light, a modern family bathroom, ample storage and SECURE,

ALLOCATED PARKING.

Available January 2025!

Call today to arrange a viewing
02392 864 974
www.bernardsestates.co.uk





Call today to arrange a viewing
02392 864 974
www.bernardsestates.co.uk



PROPERTY INFORMATION

Right to Rent

Each applicant will be subject to the right to rent checks. This is a government requirement since February 2016. We are required to check and take a copy of the original version of acceptable documentation in order to adhere to the Right to rent checks. This will be carried out at referencing stage. Please speak to a member of staff for acceptable Identification.

Removal Quotes

As part of our drive to assist clients with all aspects of the moving process, we have sourced a reputable removal company. Please ask a member of our sales team for further details and a quotation.

Tenant Fees Act 2019

As well as paying the rent, you may also be required to make the following permitted payments.

For properties in England, the Tenant Fees Act 2019 means that in addition to rent, lettings agents can only charge tenants (or anyone acting on the tenant's behalf) the following permitted payments:

- Holding deposits (a maximum of 1 week's

- rent);
- Deposits (a maximum deposit of 5 weeks' rent for annual rent below £50,000, or 6 weeks' rent for annual rental of £50,000 and above);
- Payments to change a tenancy agreement eg. change of sharer (capped at £50 or, if higher, any reasonable costs);
- Payments associated with early termination of a tenancy (capped at the landlord's loss or the agent's reasonably incurred costs);
- Where required, utilities (electricity, gas or other fuel, water, sewerage), communication services (telephone, internet, cable/satellite television), TV licence;
- Council tax (payable to the billing authority);
- Interest payments for the late payment of rent (up to 3% above Bank of England's annual percentage rate);
- Reasonable costs for replacement of lost keys or other security devices;
- Contractual damages in the event of the tenant's default of a tenancy agreement; and
- Any other permitted payments under the Tenant Fees Act 2019 and regulations applicable at the relevant time.



Energy Efficiency Rating		Current	Potential
Very energy efficient - lower running costs			
(92 plus)	A		
(81-91)	B		
(69-80)	C		
(55-68)	D		
(39-54)	E		
(21-38)	F		
(1-20)	G		
Not energy efficient - higher running costs			
England & Wales		EU Directive 2002/91/EC	



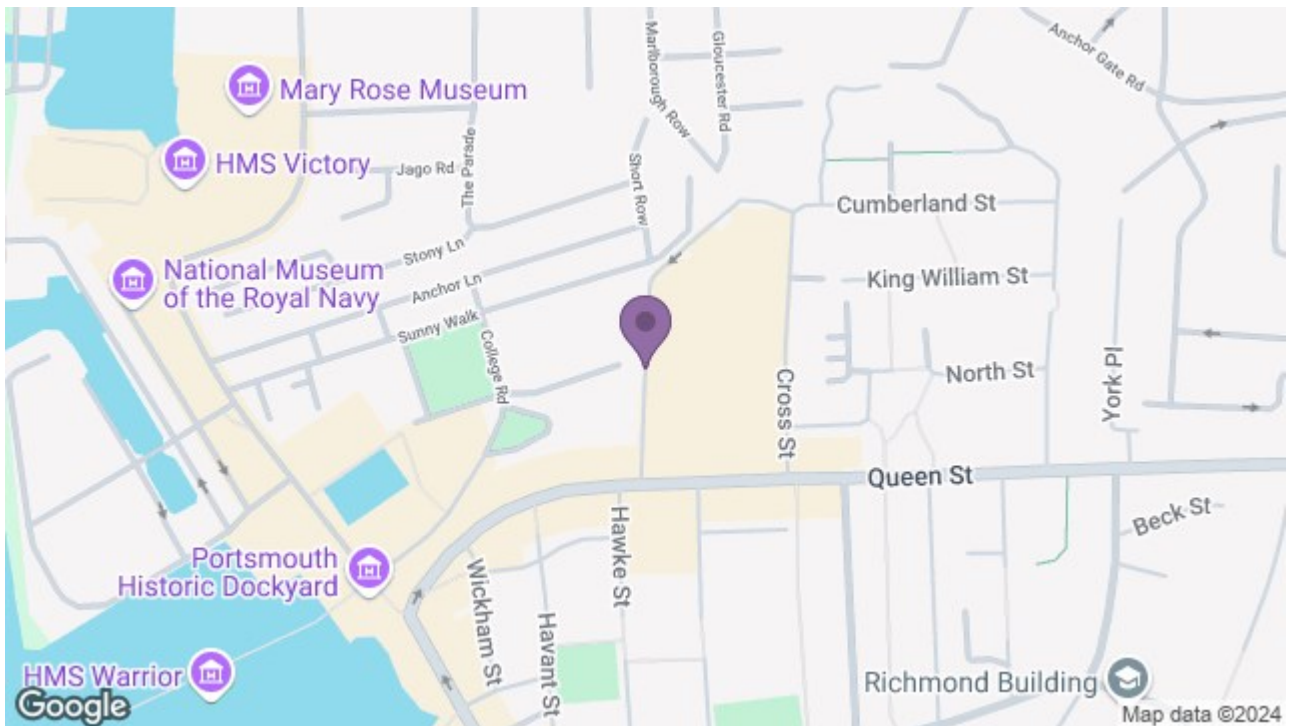
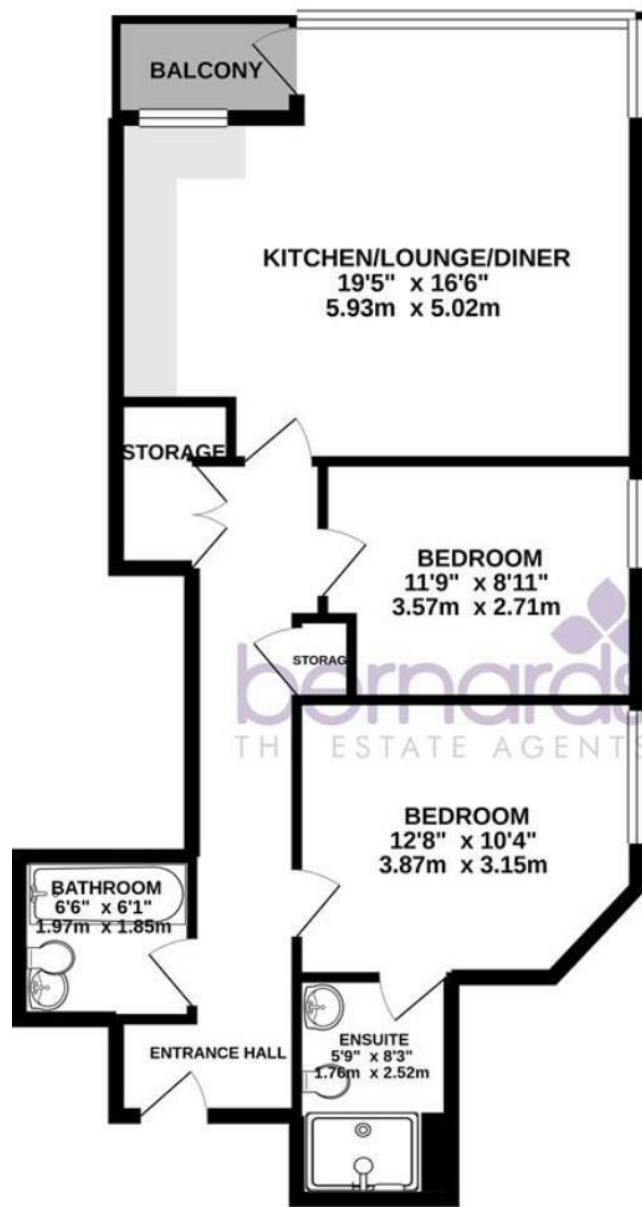

8 Clarendon Road, Southsea, Hampshire, PO5 2EE
t: 02392 864 974

