



## Leeds Road

Kippax, Leeds, LS25 7HP  
£490,000



# SIGNATURE

BY

**Emsleys** | estate agents

# Leeds Road

## Kippax, Leeds, LS25 7HP

\*\*\* FOUR BEDROOM DETACHED BUNGALOW. JUST UNDER 1/3 ACRE PLOT. THREE RECEPTION ROOMS. DINING/KITCHEN. UTILITY ROOM. MASTER WITH EN-SUITE. TRANQUIL LARGE GARDENS & AMPLE PARKING \*\*\*

We are delighted to present this charming FOUR BEDROOM DETACHED BUNGALOW, situated in a peaceful and tranquil location, located down a private driveway. The property offers spacious, versatile homely accommodation and has been a much loved family home for over 30 years. The bungalow sits on an impressive plot, occupying just under a 1/3 of an acre, with a low maintenance artificial lawn and mature shrubs and trees. The property will attract a wide range of buyers, as the bungalow has ample space for comfortable living and room to create further accommodation, should this be needed.

Upon entering, you will be greeted by the spacious garden room which provide a warm and inviting atmosphere and leads to an open-plan dining room. The lounge boasts a cosy fireplace, perfect for relaxing evenings. All the reception rooms offer stunning views of the garden, creating a tranquil ambience.

The bungalow features a well-appointed kitchen, with beautiful granite counter tops and a dining space plus a built-in hob, double oven and fridge, and a practical utility room. This allows for convenient cooking and entertaining options. There are four bedrooms in total, including a luxurious master bedroom with an en-suite bathroom and fitted wardrobes. The property benefits from a good sized family bathroom, which boasts a four-piece suite. There is potential to create a fifth bedroom to the first floor, should this be required, but currently there is a large study and landing area - ideal if you work from home. Outside, there are good sized mature gardens to the front and rear, with ample space for parking for several cars, as well as a carport for additional convenience.

- FOUR BEDROOM DETACHED BUNGALOW
- 0.29 ACRE PLOT WITH LOW MAINTENANCE GARDENS, DRIVEWAY & CARPORT
- LOUNGE, DINING ROOM & GARDEN ROOM
- DINING/KITCHEN WITH GRANITE WORKTOPS
- USEFUL UTILITY ROOM & W/C
- MASTER BEDROOM WITH AN EN-SUITE & WARDROBES
- TUCKED OUT OF THE WAY LOCATION
- COUNCIL TAX BAND F



## Ground floor

### Garden Room

7'5" x 12'1" (2.26m x 3.68m)

Double-glazed sliding patio doors with side panels, two radiators, tiled flooring, two wall light points and an archway to:

### Dining Room

8'6" x 13'3" (2.59m x 4.04m)

Radiator, serving hatch from the kitchen, coving to the ceiling and recessed spotlights.

### Inner Hallway

Two radiators, coving to the ceiling and a door to:

### Lounge

16'8" x 16'2" (5.08m x 4.93m)

Double-glazed window to the front, coal effect gas fire with a brick-built surround, radiator, coving to the ceiling, recessed spotlights, built-in window seat with storage below and double-glazed sliding patio doors to the garden.

### Master Bedroom

17'5" max x 12'6" max (5.31m max x 3.81m max )

17'5" max (14'2" min) x 12'6" max

Two double-glazed windows to the side, fitted wardrobes with hanging rails, shelving, overhead storage cupboard and drawers and a matching dressing table. Two radiators, coving to the ceiling and a door to:

### En-suite Shower Room

Fitted with a three piece suite comprising; shower enclosure, pedestal wash hand basin and a low-level WC. Extractor fan and full height tiling to all walls.

### Family Bathroom

Fitted with a four piece suite comprising; sunken corner bath, pedestal wash hand basin, shower cubicle and a low-level WC.. Full height tiling to all walls, extractor fan, radiator, coving to the ceiling, recessed spotlights, built-in storage cupboard and a double-glazed window to the rear,

### Bedroom 3

10'0" x 7'1" (3.05m x 2.16m)

Double-glazed window to the rear, radiator and coving to the ceiling.

### Bedroom 2

13'7" max x 10'5" max (4.14m max x 3.18m max)

13'7" max into wardrobe x 10'5" max

Fitted wardrobes with hanging rails and shelving, radiator, coving to the ceiling and a double-glazed window to the rear.

### Kitchen/Diner

16'10" x 9'10" (5.13m x 3.00m)

Fitted with a range of base and eye level units with granite worktop space over with drawers, a matching fitted dining table and a wine rack. One and half bowl sink unit with single drainer and mixer tap, tiled splashbacks, built-in fridge, built-in electric double oven and a built-in five ring gas hob with a pull-out extractor hood over. Double-glazed window to the side, double-glazed window to the front, radiator, coving to the ceiling and a door to:

### Utility Room

17'5" x 7'11" (5.32m x 2.42m)

Fitted with a range of base and eye level units with worktop space over with drawers, stainless steel sink unit with single drainer, double-glazed window to the side, radiator, wall mounted gas boiler, stairs to the first floor and a door to:

### WC

Fitted with low-level WC and having a double-glazed window to the side.

## First floor

### Landing

Large versatile area with skylight, radiator and being open-plan to:

### Study/Potential Bedroom

11'11" x 9'10" (3.63m x 3.00m)

Skylight and a radiator.

### Bedroom 4

12'11" x 16'1" (3.94m x 4.90m)

Skylight and access to the eaves space.

## Outside

The plot is a generous 0.29 acres, with wrought-iron gated access and leads to a long driveway and carport, offering off-road parking for several cars. There is a very generous large front garden, which is mainly lawned and for ease is artificial grass, with well stocked mature borders with shrubs and trees. In addition, there is a paved patio seating area to the front of the property with a brick-built BBQ. To

the rear, there is a generous mainly lawned garden, again for low maintenance this lawn is artificial, with a large patio seating area, garden shed and greenhouse. In addition, there is outside lighting all around the property and gardens.





### Ground Floor

Approx. 169.6 sq. metres (1716.2 sq. feet)



### First Floor

Approx. 57.0 sq. metres (613.5 sq. feet)

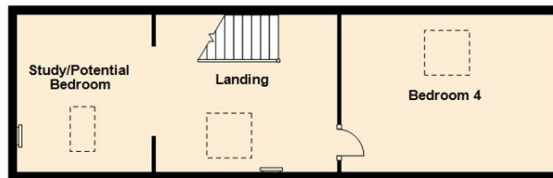

Total area: approx. 216.6 sq. metres (2331.6 sq. feet)

6 Main Street, Garforth  
Leeds LS25 1EZ

t. 0113 286 4000

e. [garforth@emsleysestateagents.co.uk](mailto:garforth@emsleysestateagents.co.uk)

35 Austhorpe Road, Crossgates  
Leeds LS15 8BA

t. 0113 284 0120

e. [crossgates@emsleysestateagents.co.uk](mailto:crossgates@emsleysestateagents.co.uk)

4 Wolsey Parade,  
Sherburn in Elmet LS25 6BQ

t. 01977 680 088

e. [sherburn@emsleysestateagents.co.uk](mailto:sherburn@emsleysestateagents.co.uk)

65 Commercial Street, Rothwell  
Leeds LS26 0QD

t. 0113 201 4040

e. [rothwell@emsleysestateagents.co.uk](mailto:rothwell@emsleysestateagents.co.uk)

[www.emsleysestateagents.co.uk](http://www.emsleysestateagents.co.uk)

These details are for guidance only and complete accuracy cannot be guaranteed. If there is any point, which is of particular importance, verification should be obtained. They do not constitute a contract or part of a contract. All measurements are approximate. No guarantee can be given with regard to planning permissions or fitness for purpose. No apparatus, equipment, fixture or fitting has been tested. Items shown in photographs are NOT necessarily included. Interested Parties are advised to check availability and make an appointment to view before travelling to see a property.



SIGNATURE

BY

Emsleys | estate agents