



Upper Tulse Hill, Brixton, SW2

£290,000

1 bedroom flat for sale

Property Details

This well-located, one double bedroom flat is full of natural light, a perfect neutral blank canvas, ready for someone to move in hassle-free. This purpose-built flat has great dimensions and will appeal to a wide range of purchasers, from first-time buyers to buy-to-let investors or anyone looking for a perfectly situated pied-a-terre. The apartment has double glazed windows throughout and comprises a spacious double bedroom with views over well-maintained grounds, a modern bathroom, an eat-in kitchen with space for a dining table and a wonderfully bright, South-West facing reception room with large windows. The property is perfectly located just off Brixton Hill, a fifteen-minute stroll to all that Brixton has to offer in terms of food and nightlife, and a ten-minute stroll to the green, open spaces of Brockwell Park and its iconic Lido. Within walking distance, you also have the centres of Clapham, Streatham Hill, Balham and Tulse Hill.

Features

- One double bedroom
- Secure purpose-built development
- Bright and airy throughout
- Double-glazed
- Set-back from the road
- Walking distance to Brixton Village and Brockwell Park

Council tax band B EPC rating C (69)



Upper Tulse Hill

K

1 Bed Flat

Approx internal area:

446 sqft 41 sqm

While we do try our very best, floor plans are produced as a guide only and we take no responsibility for the precise accuracy with which any property is represented

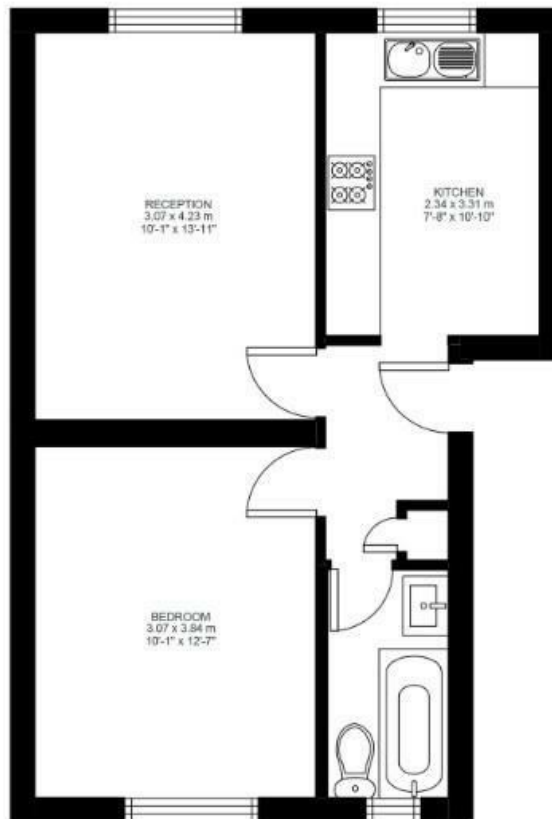

Ground Floor



Upper Tulse Hill, Brixton, SW2

